

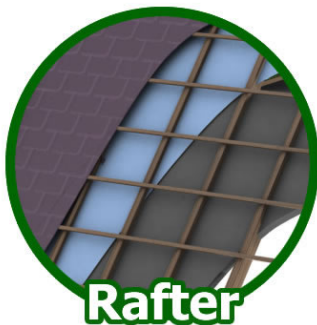

## Product Quick Guide

This quick guide is designed to show the most common places to insulate within your home, along with suggested products and recommended material depth to exceed regulation guidelines.



### Rafter

Existing/Renovation: Min 125mm  
(Layer 50mm + 75mm Premium Rolls)

New Build: 200mm  
Layer 2 x 100mm Premium Rolls

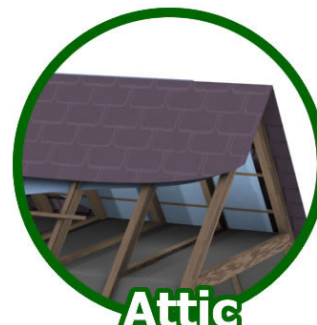

### Attic

Existing/Renovation: Min 150mm

New Build: 250mm between and over joists  
(Premium or Comfort rolls suitable)



### Internal Wall

Fill Wall to Stud Depth  
Usually 75mm/100mm Premium Rolls



### External Wall

Timber Frame: 150mm Premium rolls  
Internal Dry Lining: Min 50mm Premium rolls  
(Depending on Wall type)



### Timber Floor

Structureborne Acoustic Insulation  
Between Top Layer & Subfloor: SilentWool: Floor  
Between Subfloor & Joist: SilentWool: Joist

Airborne Acoustic/Thermal Insulation  
Insulation Roll b/n Joists: 100mm  
(Premium or Comfort rolls suitable)

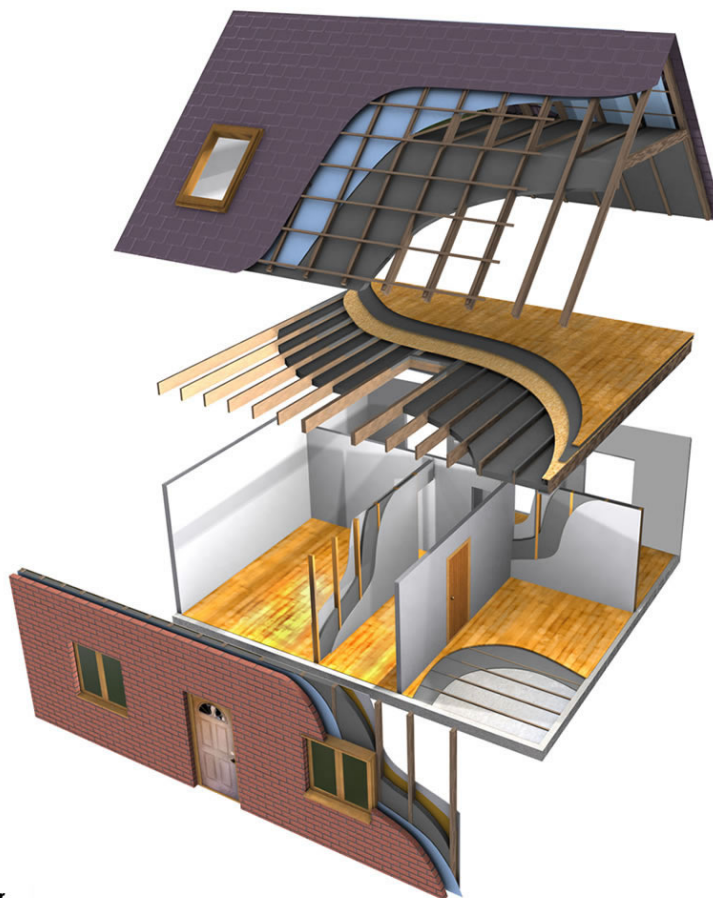

### Concrete Floor

Structureborne Acoustic Insulation  
Between Top Layer & Subfloor: SilentWool: Joist  
Between Joist & Concrete: SilentWool: Floor

Airborne Acoustic/Thermal Insulation  
Insulation Roll b/n Joists: Min 75mm  
(Premium or Comfort rolls suitable)

[www.sheepwoolinsulation.ie](http://www.sheepwoolinsulation.ie)